

# SL840V EXPLODED DIAGRAM

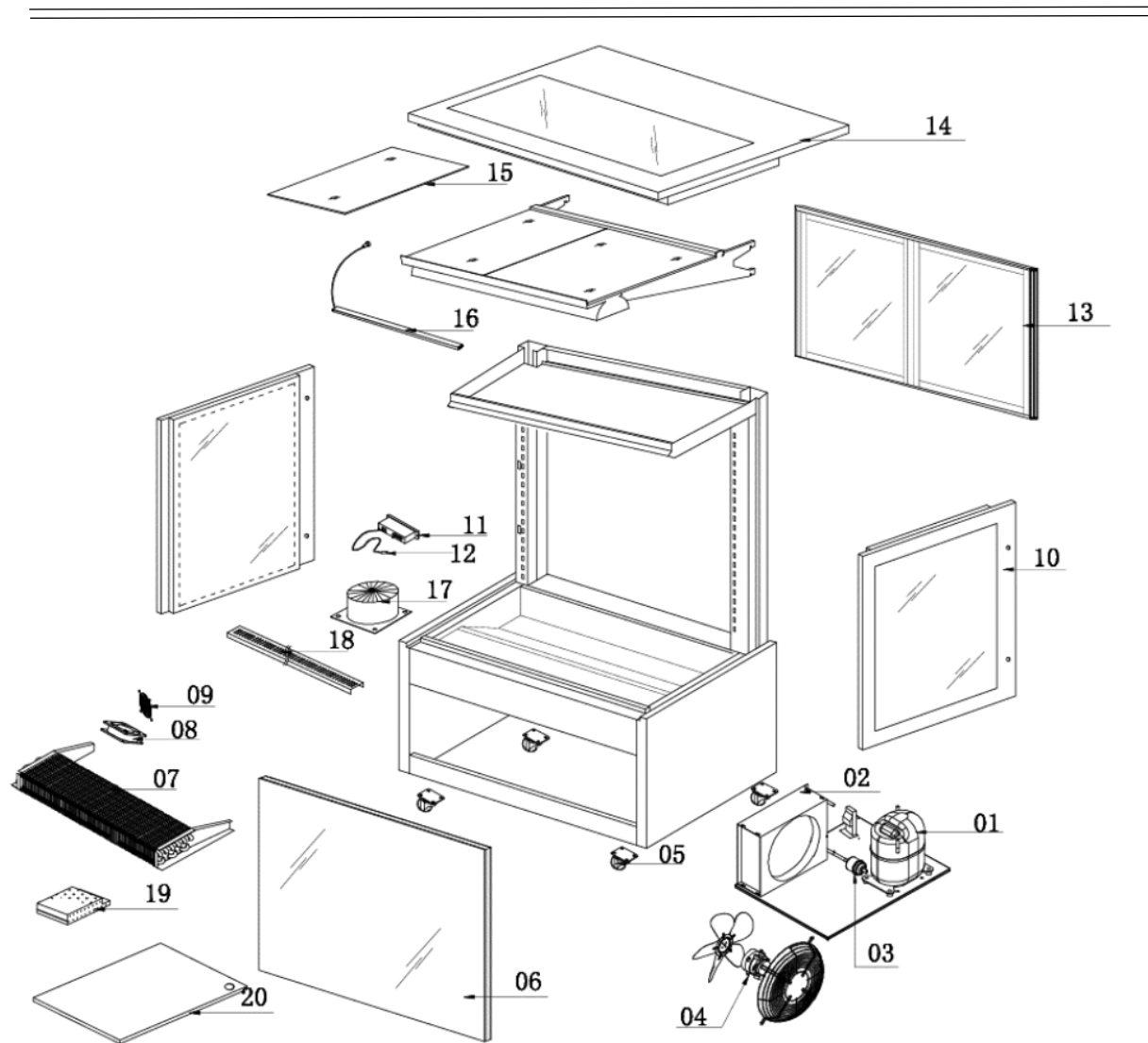

# SL840V PARTS LIST

Item	FHE Part Code	Description	Qty	Remark
1*	SC15MFX	Compressor R134A	1	
2*	Version 1 SL840V-7	Condenser 3 X 8 X 500	1	2019 Version
2*	Version 2 SL850V-7	Condenser 4mm X 8mm X 500mm	1	2024 Version
3*	<b>Drier-1</b>	<b>Filter Drier DML032S</b>	1	
4*	SL830V-CM	Condenser Motor 31W	2	
5	Version 1 <b>SLP830C-13</b>	<b>Normal Castor 2 Inch</b>	4	
5	Version 2 <b>SLP830C-14</b>	<b>Brake Castor 2 Inch</b>	4	
6*	SL840V-1	Front Square Glass 1128mm X 851mm	1	
7*	SL840V-6	Evaporator 6mm X 4mm X 870mm	1	
8*	Version 1 FAN-120X120MM	Metal Body Plastic Blade Fan EBM9656/B02 120mm X 120mm X 38mm	3	
8*	Version 2 <b>FAN-04</b>	Metal Body Plastic Blade Square Fan 120mm X 120mm X 38mm	3	
9	SL830V-FC	Fan Cover 120mm X 120mm	3	
10*	Left SL830V-2	Left Side Glass 720mm X 858mm	1	
10*	Right <b>SL830V-2A</b>	Right Side Glass 720mm X 858mm	1	
11*	Version 1 <b>TEMP CONT SF-212</b>	Temperature Controller SF-212	1	2019 Version
11*	Version 2 <b>TC-SF-172E</b>	Temperature Controller SF-172E	1	2024 Version
12	SL830V-PW	Wire of Probe Black/White	1	
13	SL840V-4	Rear Sliding Door 510mm W X 788mm H	2	

# SL840V PARTS LIST

Item	FHE Part Code	Description	Qty	Remark	
14*	SL840V-3	Top Glass 1175mm X 730mm	1		
15*	SL840V-14	Black Glass Shelf 523mm X 350mm X 4mm	6		
16*	COLD	SG120FA-LED A	LED Light Cool White 876mm	4	
16*	WARM	SG120FA-LED	LED Light Warm White 876mm	4	
17*	SL840V-CTT	Cylindrical Type Transformer 250W 40V	1		
18	SL840V-SSADP	Stainless Steel Air Duct Plate 1020mm X 77mm	2		
19*	SG-SL-LT-60W	LED Light Transformer 60W 12V 5A	1		
20	SL840-BP	Bottom panel set, 2 pcs, 394*510mm	1		
	SL830V-SSN	Shelf Screw And Nut			
	BPT-Side	Black Plastic Trim Left/Right Side 1 pcs			
	GG/SG-11	Glass Flat Screw and Gasket			
	Plug-Socket-Set	Light Plug and Socket Set			
	SL840V-4A	Door Track			
	SL840V-5	Shelf Support Complete (light & glass shelf incl.)			
	SL840V-50	Wire Rack/Shelf 523mm X 350mm			
	SL840V-FP	Front Panel No Hole			
	SL-Drain Tube	Half-thread Drain Tube			
	TBPT-1200mm	Top Black Plastic Trim Suit 1200mm Long Machine			

# SL840V PARTS LIST

---

---

\*Wearable parts

FHE After Sales Service & Support (AU)  
Phone: 1300887055  
Spares Email: [spares@fedservices.com.au](mailto:spares@fedservices.com.au)

FHE After Sales Service & Support (NZ)  
Phone: 09 415 6471  
Service Email: [service@fedproducts.co.nz](mailto:service@fedproducts.co.nz)