

MPR-6 EXPLODED DIAGRAM

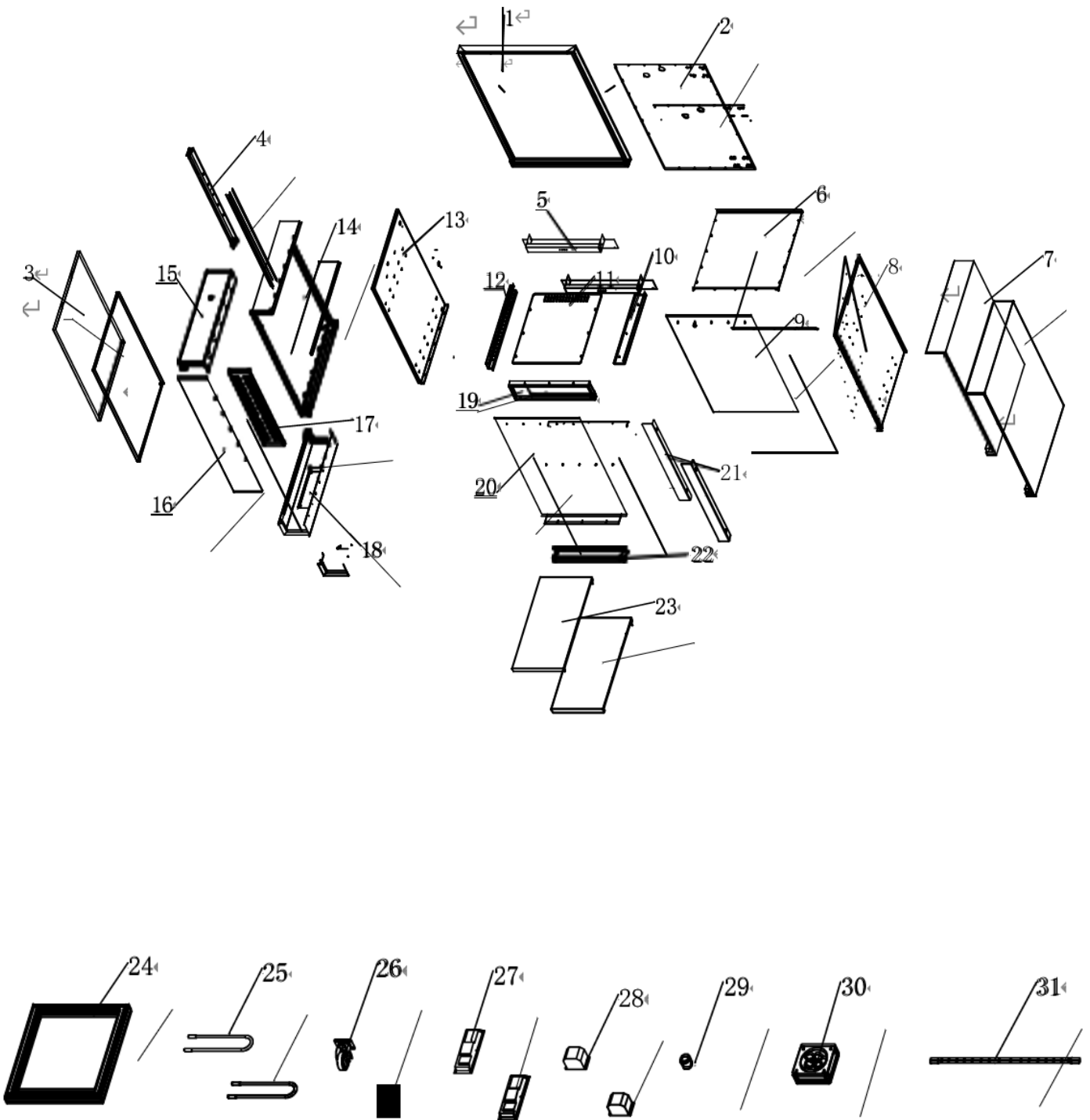

MPR-6 PARTS LIST

Item	FHE Part Code	Description	Qty
1	MPR-6-C	Countertop	1
2	MPR-6-OBBP	Outer Box Bottom Plate	1
3	MPR-6-EEBSP	External Electrical Box Side Panel	1
4	MPR-6-OBSB	Outer Box Side Beam	2
5	MPR-6-OBTB	Outer Box Top Beam	1
6	MPR-6-LBLSP	Inner Box Left Side Panel	1
7	MPR-6-OBRSP	Outer Box Right Side Panel	1
8	MPR-6-IBRSP	Inner Box Right Side Panel	1
9	MPR-6-IBBP	Inner Box Bottom Plate	1
10	MPR-6-IRCF	Inner Right Cover Fixed	2
11	MPR-6-IBRC	Inner Box Rear Cover	1
12	MPR-6-GRSP	Guide Rail Support Plate	4
13	MPR-6-IBLSP	Inner Box Left Side Panel	1
14	MPR-6-OBLSP	Outer Box Left Side Panel	1
15	MPR-6-RLP	Rear Left Pillar	1
16	MPR-6-FB	Foam Baffle	1
17	MPR-6-RMB	Reinforced Mounting Base	1
18	MPR-6-CMP	Controller Mounting Plate	1
19	MPR-6-FMP	Fan Mounting Plate	1
20	MPR-6-IBTP	Inner Box Top Plate	1
21	MPR-6-G	Guide	12
22	MPR-6-BB	Bottom Beam	1
23	MPR-6-OBRP	Outer Box Rear Panel	1
24	MPR-6-CD	Complete Door 180500000	1
25*	182000036	Heating Tube 220V 700W	1
26	183200003	Normal Castor 4 Inch Rubber	4
27*	182400045	Controller	1
28*	182400043	AC Contactor	1
29*	182900009	Solenoid Valve	1
30*	132500013	Fan Motor 220V 23W	2
31*	132600002	LED Light 220V 3.5W	1
	182400045	Control Board	
	MPR-6-BDH	Bottom Door Hinge 133110035	
	MPR-6-TDH	Top Door Hinge 133110035	
	MPR-6-LGR	Left Guide Rail	
	MPR-6-RGR	Right Guide Rail	

MPR-6 PARTS LIST

Item	FHE Part Code	Description	Qty
	132200002	Brake Castor 4 Inch Rubber	
	183400000	Baking Pan 400m X 600mm	
	MPR-6-THS	Temperature and Humidity Sensor	

*Wearable parts