

SL850V EXPLODED DIAGRAM

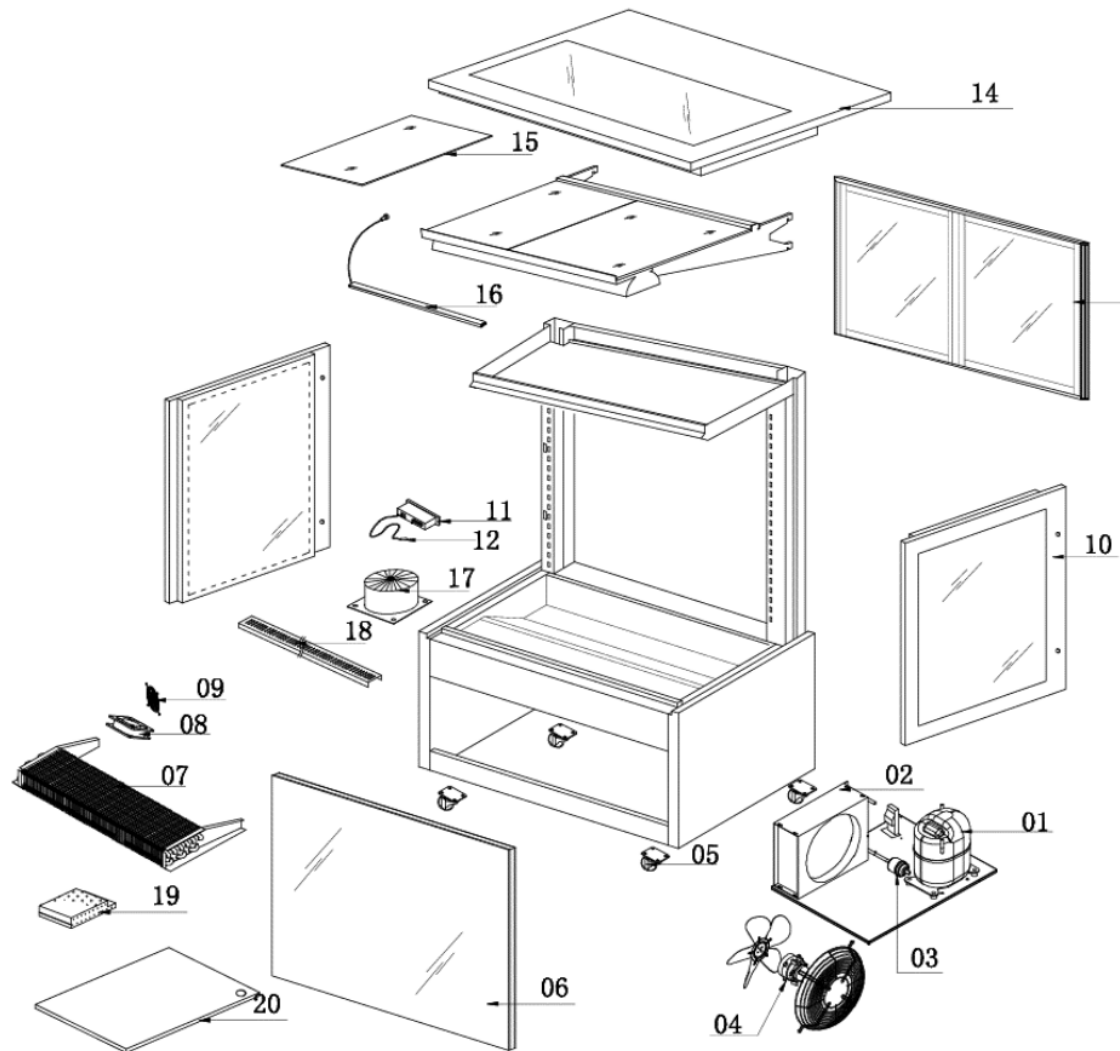

SL850V PARTS LIST

Item	FHE Part Code	Description	Qty	Remark
1*	SC18G	Compressor R134a	1	
2*	SL850V-7	Condenser 4mm X 8mm X 500mm	1	
3*	Drier-1	Filter Drier DML032S	1	
4*	SL830V-CM	Condenser Motor 31W	2	
5	Version 1 SLP830C-13	Normal Castor 2 Inch	4	
5	Version 2 SLP830C-14	Brake Castor 2 Inch	4	
6*	SL850V-1	Front Square Glass 1428mm X 851mm	1	
7*	SL850V-6	Evaporator 6mm X 4mm X 1170mm	1	
8*	Version 1 FAN-120X120MM	Metal Body Plastic Blade Fan EBM9656/B02 120mm X 120mm X 38mm	4	
8*	Version 2 FAN-04	Metal Body Plastic Blade Square Fan 120mm X 120mm X 38mm	4	
9	SL830V-FC	Fan Cover 120mm X 120mm	4	
10*	Left SL830V-2	Left Side Glass 720mm X 858mm	1	
10*	Right SL830V-2A	Right Side Glass 720mm X 858mm	1	
11*	Version 1 TEMP CONT SF-212	Temperature Controller SF-212	1	2019 Version
11*	Version 2 TC-SF-172E	Temperature Controller SF-172E	1	2024 Version
12	SL830V-PW	Wire of Probe Black/White	1	
13	SL850V-4	Rear Sliding Door 788mm H X 648mm W	2	
14*	SL850V-3	Top Glass 1475mm X 730mm	1	

SL850V PARTS LIST

Item	FHE Part Code	Description	Qty	Remark	
15*	SL850V-14	Black Glass Shelf 675mm x 350mm x 6mm	6		
16*	COLD	SG150FA-LED A	LED Light Cool White 1180mm	4	
16*	WARM	SG150FA-LED	LED Light Warm White 1180mm	4	
17*	SL850V-CTT	Cylindrical Type Transformer 300W 50V	1		
18	SL850V-SSADP	Stainless Steel Air Duct Plate 1320mm X 77mm	2		
19*	SG-SL-LT-98W	LED Light Transformer New Version 7A 98W	1		
20	SL850V-BP	Bottom Panel Set 394mm X 660mm	2		
	GG/SG-11	Glass Flat Screw and Gasket			
	GG-SC-XB	BOTTOM END CAP			
	GG-SC-XT	TOPSHELF END CAP			
	SL850V-4A	Door Track			
	SL850V-FP	Front Panel			
	SL-Drain Tube	Half-thread Drain Tube			
	SL830V-SSN	Shelf Screw And Nut			

*Wearable parts

FHE After Sales Service & Support (AU)
 Phone: 1300887055
 Spares Email: spares@fedservices.com.au

FHE After Sales Service & Support (NZ)
 Phone: 09 415 6471
 Service Email: service@fedproducts.co.nz