

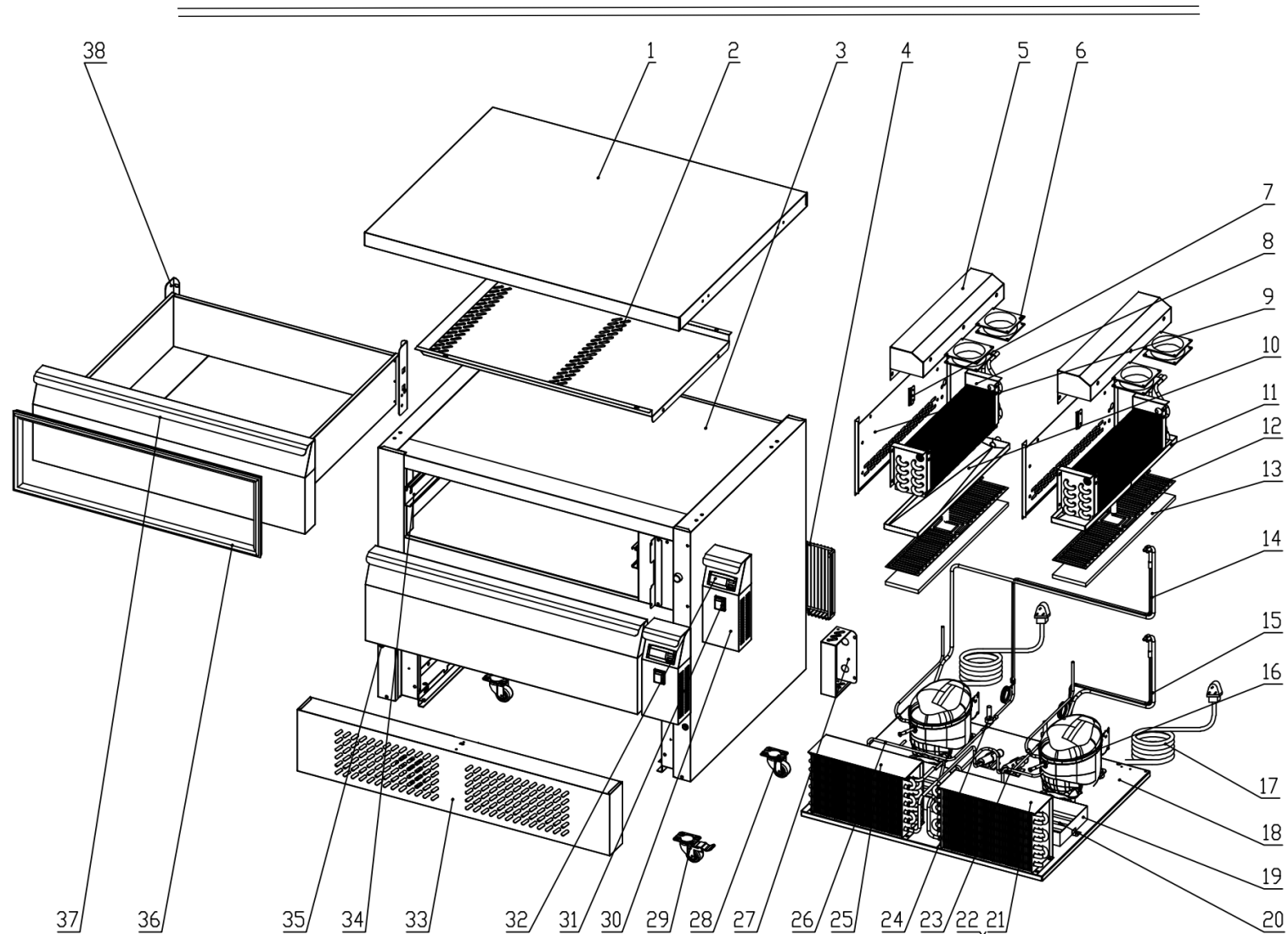

CBR2-3 EXPLODED DIAGRAM



CBR2-3 PARTS LIST

Item	FHE Part Code	Description	Qty	Remark
1	CBR1-3.01	Top 1230mm X 700mm X 40mm	1	
2	CBR1-3.02	AIR FLOW CONDUCT BOARD	1	
3		BODY	1	
4*	CBR1-3.04	Unite Room Grills	1	
5	CBR1-2.05	The Fan Support 5114000508	1	
6*	104030032	Circle Fan SA9225A2HBT	2	
7	S900.31	Sensor Fixed Clip 5202002366	1	
8*	CBR1-2.08	Evaporator	2	
9	CBR1-2.09	Evaporator Cover 5202000256 521mm X 226mm	2	
10	CBR1-2.10	Water Pan 5202003044 522.6mm X 129.8mm	1	
11	CBR2-2.10	Water Pan 5202001398 530.4mm X 127mm	1	
12*	CBR1-2.12	Defrost Heating Element 104130006	2	
13	106050458	HEAT PRESERVATION FOAM 106050458	2	
14	CBR2-3.14	MUFFLER	1	
15	CBR1-2.13	MUFFLER	1	
16*	EMT2121U	Embraco R290 5.57CC Compressor 104010101	2	

FHE After Sales Service & Support (AU)
 Phone: 1300887055
 Spares Email: spares@fedservices.com.au

FHE After Sales Service & Support (NZ)
 Phone: 09 415 6471
 Service Email: service@fedproducts.co.nz

CBR2-3 PARTS LIST

Item	FHE Part Code	Description	Qty	Remark
17	S900.47	PLUG 104050042	2	
18	CBR1-3.16	Unit Board	1	
19	CBR1-2.17	WATER PAN 5114000739	2	
20	CBR1-2.18	Discharge Pipe 113110445	1	
21*	CBR1-2.19	CONDENSER	1	
22*	BC2-24.09	Condenser Fan Motor SA1725A2 HBT 104030114	2	
23	S900.44	Filter Drier	2	Replaced by Drier-1
24*	D3.24	Solenoid Valve CSV2	1	
25*	CBR2-2.25	Condenser 5111000024	1	
26	CBR2-2.26	Discharge Pipe 113110444	1	
27	CBR1-2.23	PROTECTOR BOX	1	
28	CBR1-2.24	Standard 2.5" Light Medium Swivel Caster 107050023	2	
29	CBR1-2.25	Braked 2.5" Light Medium Swivel Caster 107050024	2	
30	CBR1-2.26	Front Panel 5114000495	2	
31*	S900.01	Main Switch 104090001	2	
32*	TEMP.CONTROLLER	Temperature Controller Dixell/Copeland XR06C	2	

CBR2-3 PARTS LIST

Item	FHE Part Code	Description	Qty	Remark
33	CBR1-3.29	Down Front Panel	1	
34*	Left	107250040	GUIDE LEFT 750 L=550mm (B)	2
34*	Right	107250041	GUIDE RIGHT 750 L=550mm (B)	2
35	GN650TN.01	SUPPORT TRAY NUT 108300162	2	
36*	CBR1-3.32	Door Seal	2	
37	CBR1-3.33	DRAWER	2	
38	CBR1-2.34	Back Support 5202000258 200mm X 67.5mm	2	

*Wearable parts