

CBR2-2 EXPLODED DIAGRAM

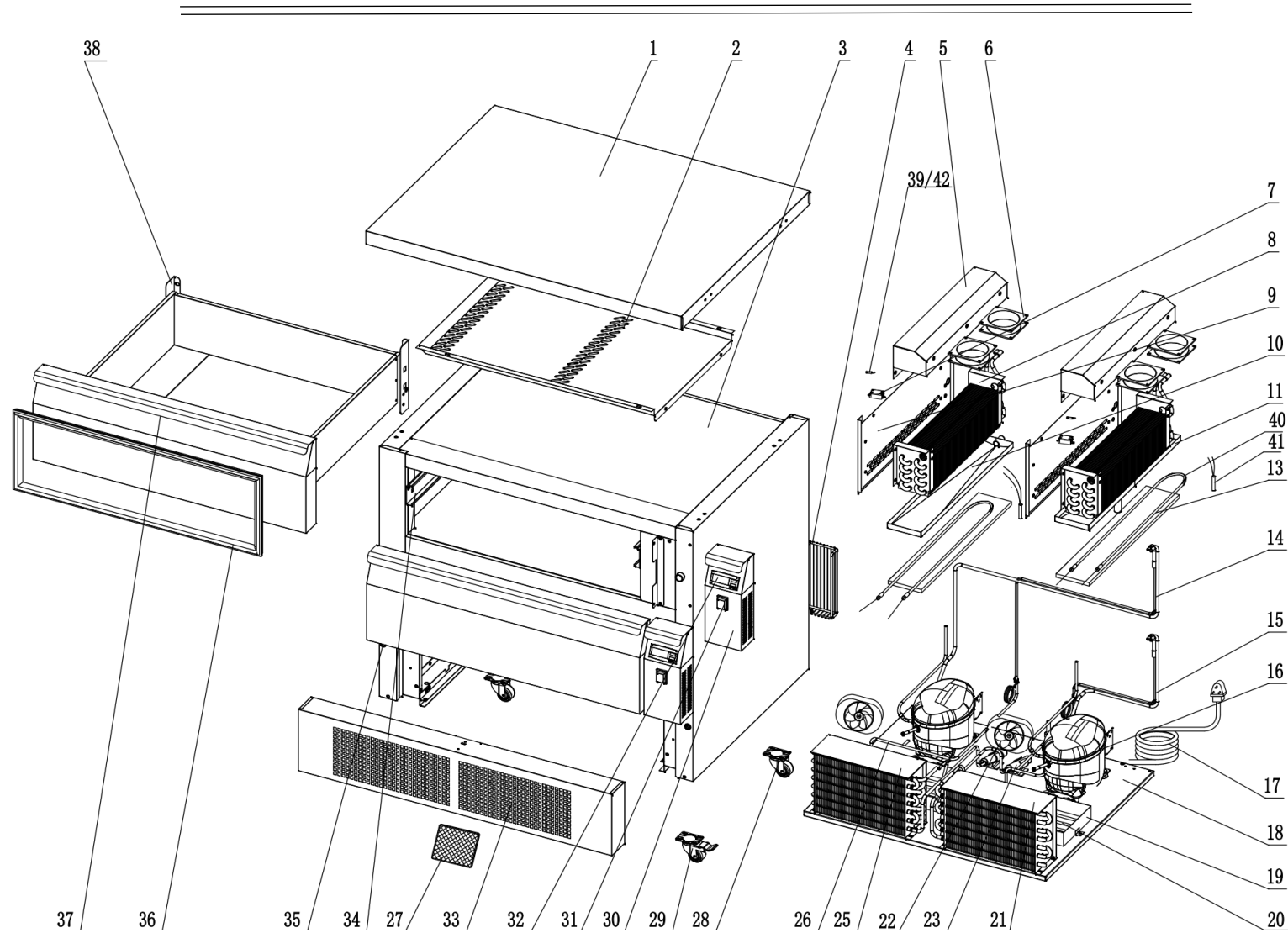

CBR2-2 PARTS LIST

Item	FHE Part Code	Description	Qty	Remark
1	5108000066	Top	1	
2	5202000257	AIR FLOW CONDUCT BOARD 704mm X 487mm	2	
3	5102001880	BODY	1	
4*	109030077	Unite Room Grills	1	
5	5114000508	The Fan Support	2	
6*	104030032	Circle Fan SA9225A2HBT	4	
7	5202002366	Sensor Fixed Clip	2	
8*	5112000591	Evaporator	2	
9	5202000256	Evaporator Cover 521mm X 226mm	2	
10	5202001398	Water Pan 530.4mm X 127mm	1	
11	5202003044	Water Pan 522.6mm X 129.8mm	1	
13	106050458	HEAT PRESERVATION FOAM	2	
14	113100639	Connecting Pipe Group Upper	1	
15	113100640	Connecting Pipe Group Lower	1	
16*	EMT2121U	Embraco R290 5.57CC Compressor 104010101	2	
17	104050042	PLUG AU10-28 JST	1	

FHE After Sales Service & Support (AU)
 Phone: 1300887055
 Spares Email: spares@fedservices.com.au

FHE After Sales Service & Support (NZ)
 Phone: 09 415 6471
 Service Email: service@fedproducts.co.nz

CBR2-2 PARTS LIST

Item	FHE Part Code	Description	Qty	Remark
18	5202003043	Unit Board 700mm X 630mm	1	
19	5114000739	WATER PAN TUC-48	2	
20	113110445	Discharge Pipe	1	
21*	5111000025	CONDENSER	1	
22*	BC2-24.09	Condenser Fan Motor SA1725A2 HBT 104030114	2	
23	Drier-1	DRIER LIQUID LINE DML032S 1/4 SOLDER	2	
25*	CBR2-2.25	Condenser 5111000024	1	
26	113110444	Discharge Pipe	1	
27*	107240046	Condenser Filter Panel	2	
28	107050023	Standard 2.5" Light Medium Swivel Caster	2	
29	107050024	Braked 2.5" Light Medium Swivel Caster	2	
30	5114000495	Front Panel	2	
31*	S900.01	Main Switch 104090001	2	
32*	TEMP.CONTROLLER	Temperature Controller Dixell/Copeland XR06C	2	
33	5202010347	Down Front Panel 1086mm X 367mm	1	
34*	Left	GUIDE LEFT 750 L=550mm (B)	2	

CBR2-2 PARTS LIST

Item		FHE Part Code	Description	Qty	Remark
34*	Right	107250041	GUIDE RIGHT 750 L=550mm (B)	2	
35		GN650TN.01	SUPPORT TRAY NUT 108300162	2	
36*		108270386	Door Seal Black 696mm X 220mm	2	
37		5113000075	DRAWER	2	
38		5202000258	Back Support 200mm X 67.5mm	4	
39*		104020097-104020099	Black Temperature Sensor With 1.5M Wire And Jst Connector 104020097+104020099	1	
40*		104130006	Defrost Heating Element	2	
41*		104120110	Protector for Heating Element	2	
42*		104020093-104020095	White Temperature Sensor With 1.5M Wire And Jst Connector 104020093+104020095	1	

*Wearable parts